

# Temporary Trestle Railroad Bridge for Sale or Rent

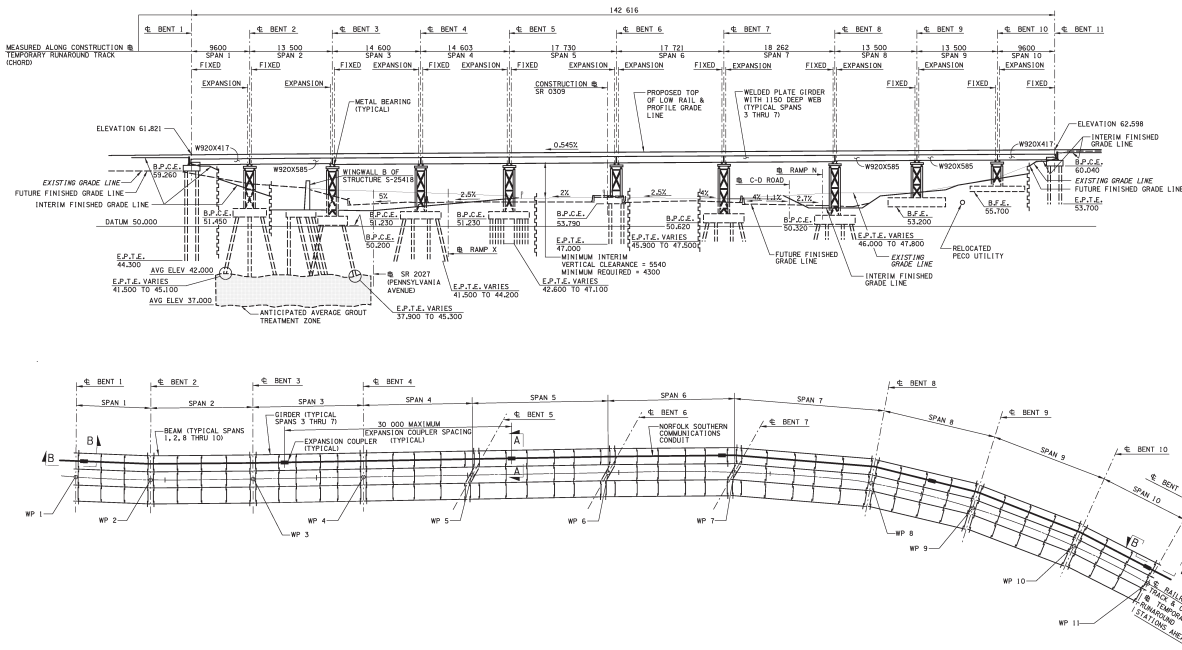

**Detour Structure:** This 467-foot bridge is comprised of ten spans, and is available immediately from our Rhode Island storage depot.

The structure was designed by Gannett Fleming to the current AREMA specifications and fabricated by High Steel Structures

with full PennDOT shop inspection.

The 734-ton bridge was erected in August 2005 and is now disassembled and ready for shipment.

Contact Bernie Mares for engineering calculations, CAD drawings, test reports and pricing.

This information and that on our website is accurate to the best of our knowledge. We do not represent this material to be suitable for any intended purpose. All information including completeness of inventory and accuracy of drawings and other information should be verified by any prospective buyer. Subject to prior sale.



**VERSA-STEEL INC.**  
HELPING TO BUILD FIRM FOUNDATIONS SINCE 1976

Phone (503) 287-9822 Fax (800) 287-7483  
www.VersaSteel.com Bernie@VersaSteel.com

Call Bernie at  
**1-800-678-0814**

To delete your fax number from our list please call: 800-440-6358 x44420.